

Plot #052

6	* Felix A. 1879-1945 Jones	Obed L. Monroe 1937 (permit & old plot map)	1
5	* Myrtle E. 1877-1940 (top, shared—both: old plot map)	* Laura E. Monroe Apr 23, 1869 Feb 24, 1930 (E side—permit, receipt & old plot map)	2
4	* to my husband J. B. Carder born Aug 9, 1864 died Oct 13, 1890 (sml. Gothic obelisk w/ribbon & flor. des., E side—old plot map)	* Clarence D. Carder 1887-1921 Here rests a Woodman of the World (top w/curb & engrv'd: md WOW stump des. w/ mallet on marker, "CDC" w/ Master Mason/compass/sqr./"G" @ base of curb —permit & old plot map)	3



* headstone in place—7/2007

Plot #052

approx. headstone placement

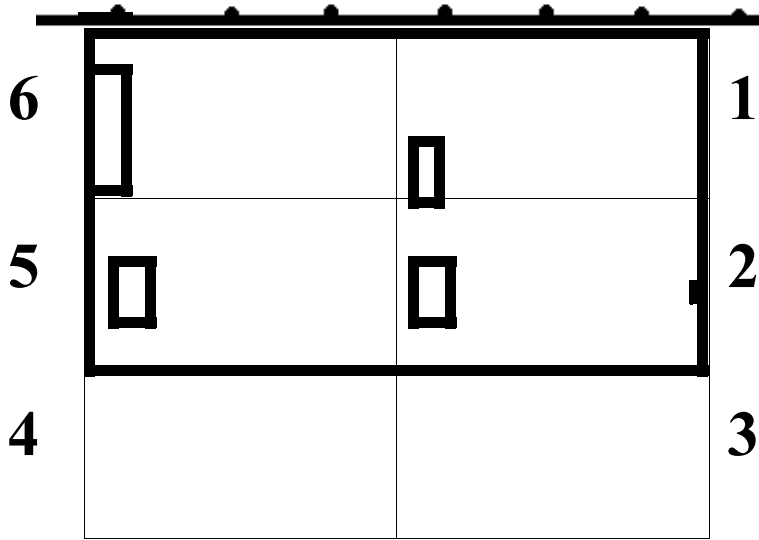

■ = curb engraving loc.

—●—●—●— = perimeter fencing

Plot enclosure: concrete curb as shown