

# Plot #057

<b>8</b>	<b>Fouts</b> (old plot map only— no other info.)	*	<b>Thorpe</b> <b>Ida M. 1861-1915</b> <b>Eugene L. 1854-1921</b> (top, shared—old plot map)	<b>1</b>
<b>7</b>	<b>Baby son of S.A. &amp; Gunda Fossen</b> <b>June 22, 1908</b> * <b>Arthur Louis son of S.A. &amp; Gunda</b> <b>Fossen 1907</b> (old plot map, both—see notes next pg.)		<b>Baby Boy Lamb</b> <b>1933</b> (permit & old plot map)	<b>2</b>
<b>6</b>	<b>Edith Welch</b> <b>1906</b> (old plot map only)		<b>Shows reserved for Lamb on</b> <b>old plot map.</b>	<b>3</b>
<b>5</b>	* <b>Bennett</b> Father <b>Thomas 1842-1934</b> Mother <b>Mary G. 1851-1933</b> (top, slant, shared— tree leaning over stone— permit & old plot map, both)		<b>Baby Anderson 1937</b> (old plot map only) Mother * <b>Eliza A. Green</b> <b>1854-1932</b> (top, slant, cracked glass loose on base, flor.des.—permit, receipt & old plot map)	<b>4</b>
<b>5A</b>	<b>Wright</b> <b>Thelma B. Dec 4, 1903-Dec 14, 1933</b> <b>Lee Cary Sept 25, 1902-Feb 17, 1985</b> Married Nov 11, 1922 (E side w/tree & river des., shared—permit & old plot map Thelma only)		* <b>Annie Maude Pearson</b> <b>1884-1950</b> (top, leaning tree—old plot map) Father * <b>Arthur L. Wright</b> <b>1872-1939</b> (top, slant, loose glass on base, matches Green—permit & old plot map)	<b>4B</b>



\* headstone in place—8/2007

# Plot #057

approx. headstone placement

E side: double heart w/dove above names on each side & flor. des. @ base & concrete curb:

**Baby** son of S.A. & Gunda **Fossen**  
**June 22, 1908**

**Arthur Louis** son of S.A. & Gunda  
**Fossen** born **Feb 16**  
 died **Aug 16, 1907**

"Sleep on sweet babies and take thy  
 rest, God called you home,  
 He thought it best"

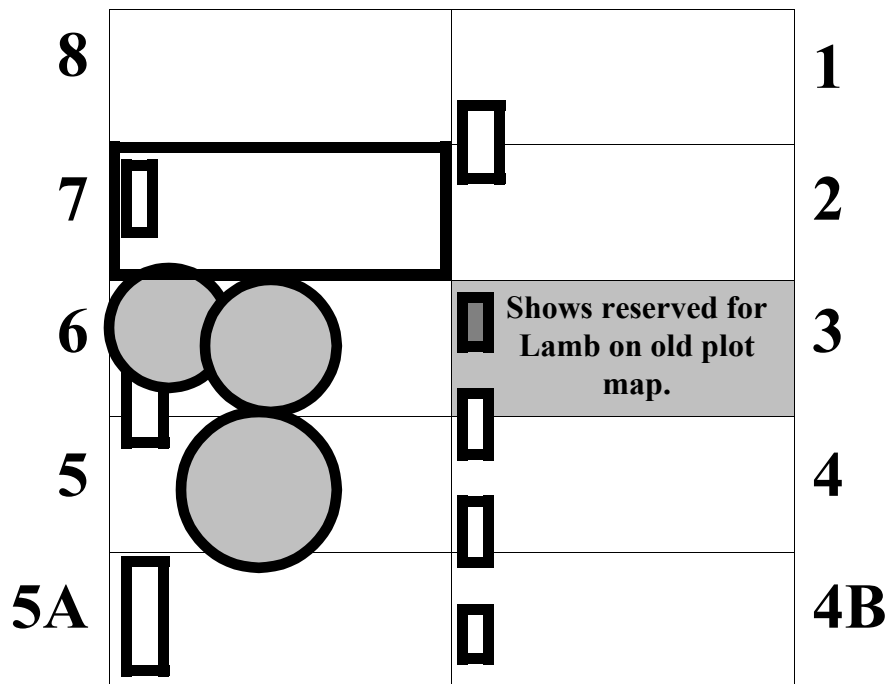

● = boxwoods & lilacs

▭ = broken base, no marker

Plot enclosure: concrete curb as shown