

# Plot #075

	space assigned to plot #076—on old plot map	* <b>Mary E. Grider</b> 1876-1956 (top w/cross—old plot map)	<b>1B</b>
<b>8</b>	"Unknown" (old plot map)	* <b>William L. Grider</b> 1874-1962 (top w/cross—old plot map)	<b>1</b>
<b>7</b>	* <b>Frederick Lehman</b> born <b>May 30, 1837</b> died <b>Sep 23, 1894</b> (shared—GAR & old plot map) <div style="border: 1px solid black; padding: 2px; width: fit-content; margin: 5px auto;">Lehman</div>	<b>Elizabeth Lehman</b> 1910 (old plot map only)	<b>2</b>
<b>6</b>	* <b>Adelheid Lehman</b> 1841-1936 (obelisk, see next pg—permit & old plot map)	* <b>Miriam L. Fisch</b> 1911-1924 (top—permit & old plot map)	<b>3</b>
<b>5</b>	* In Memory of <b>Melchior Durst</b> born <b>Dec 26, 1804</b> died <b>Sept 19, 1885</b> (E side, crv'd top—old plot map)	* <b>Pieper</b> <b>Fred 1850-1942</b> <b>Katharine 1862-1956</b> (top, shared—old plot map)	<b>4</b>
	space assigned to plot #074—on old plot map	* <b>Magdalene Stucky</b> 1828-1920 (top, matches Stucky mrkrs in #074—permit & old plot map)	<b>4B</b>



\* headstone in place—6/2008

obelisk, shared on base—E side: city towers w/  
cloud border @ top

"In my father's house are many mansions"

**Frederick Lehman**

**born May 30, 1837**

**died Sep 23, 1894**

S & W side: plain

N side: **Adelheid Lehman**

**1841-1936**

## Plot #075

approx. headstone placement

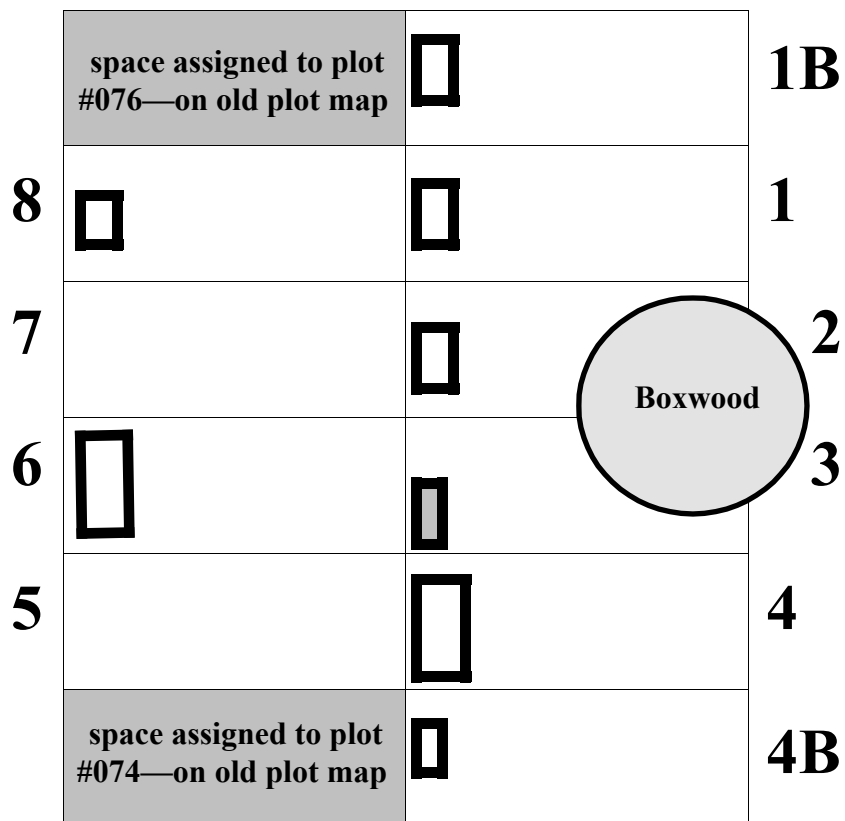

 = red brick base w/no stone

Plot enclosure: none