

# Plot #107

	<b>McLean</b>	
	* <b>William J. 1868-1938</b> (E side, shared ((see plot #106)) w/flrl engrv'd des—permit & old plot map)	<b>1B</b>
<b>8</b>	* <b>Vivian Elizebeth Payne</b> born <b>Feb 22, 1902</b> died <b>May 17, 1912</b> (E side, hrt shp'd shield w/engrv'd rose @ top— old plot map)	<b>1</b>
	<b>Pick</b>	
<b>7</b>	* <b>Mary C. Glover</b> <b>1963</b> (old plot map only as "reserv'd for Mrs.") * <b>Loren B. Glover</b> <b>1954</b> (old plot map)	<b>2</b>
<b>6</b>	* <b>Howard L. Conover 1891-1959</b> (top—old plot map) * <b>Merwyn G. Brother 1929-1985</b> (top, shared w/flrl engrv'd cross—no other recs) <div style="text-align: center;"><b>Conover</b></div> * <b>Elodee V. Sister 1920-1967</b> (poss on old plot map as "daughter" see #2) * <b>Mary A. Smith wife of A. Sovern</b> born <b>Nov 25, 1852</b> died <b>Oct 31, 1884</b> (E side, crv'd top—old plot map)	<b>3</b>
<b>5</b>	* <b>Amos Sovern</b> <b>1920</b> (permit & old plot map)	<b>4</b>
	* <b>P. J. Lutz</b> <b>1863-1938</b> (top—permit & old plot map)	
	* <b>Mother Anna Lutz</b> <b>1868-1953</b> (top—old plot map)	<b>4B</b>
	* <b>Anna Lutz</b> <b>1868-1953</b> (top—old plot map)	



**N**

\* headstone in place—8/2008

# Plot #107

approx. headstone placement

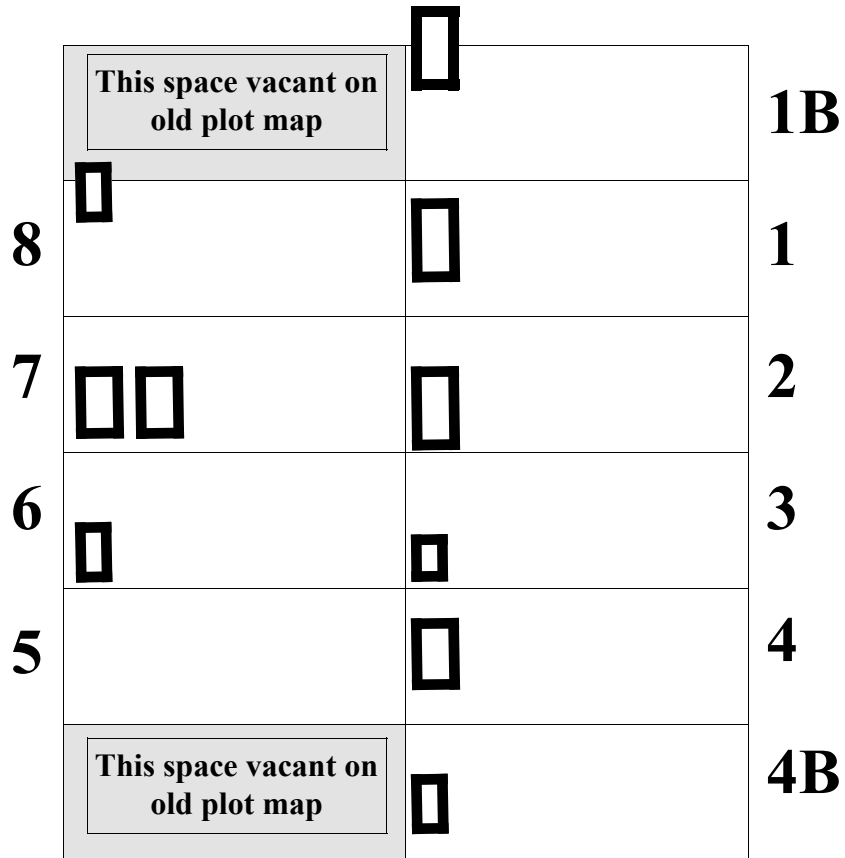

Plot enclosure: none