

Plot #156

6	Fannie Sayre 1911 <small>(old plot map only)</small>	* Charles F. Moreland 1974 <small>(old plot map only)</small> * Bessie M. Moreland 1936 <small>(permit, old plot map)</small>	1
5	Mrs. Charles Hanthorn 1960 <small>(shows as reserved only on old plot map)</small> * Charles Hanthorn 1884-1940 <small>(top w/H in circ & flrl des—old plot map)</small>	Reserved for [illeg., poss. Chas.?] Moreland on old plot map.	2
4	* Beula Baby dau. of AJ & NN Peiffer born Sept 11, 1901 died Sept 13, 1902 * <small>(E side, see notes next pg—old plot map)</small> Baby Sharon Lynn Stutzman 1942-1943 <small>(top—old plot map)</small>	* Emma T. Devine 1885-1971 <small>(E side—old plot map)</small>	3
	This space not numbered on old plot map.	* James Henry Devine 1864-1940 At Rest <small>(E side—permit, old plot map)</small>	3B



* headstone in place—8/2008

Plot #156

approx. headstone placement

on top of marker: **Beula**
E side: Baby dau. of AJ & NN
Peiffer born **Sept 11, 1901**
died **Sept 13, 1902**
favored of heaven to wear the crown
without life's weary race to run

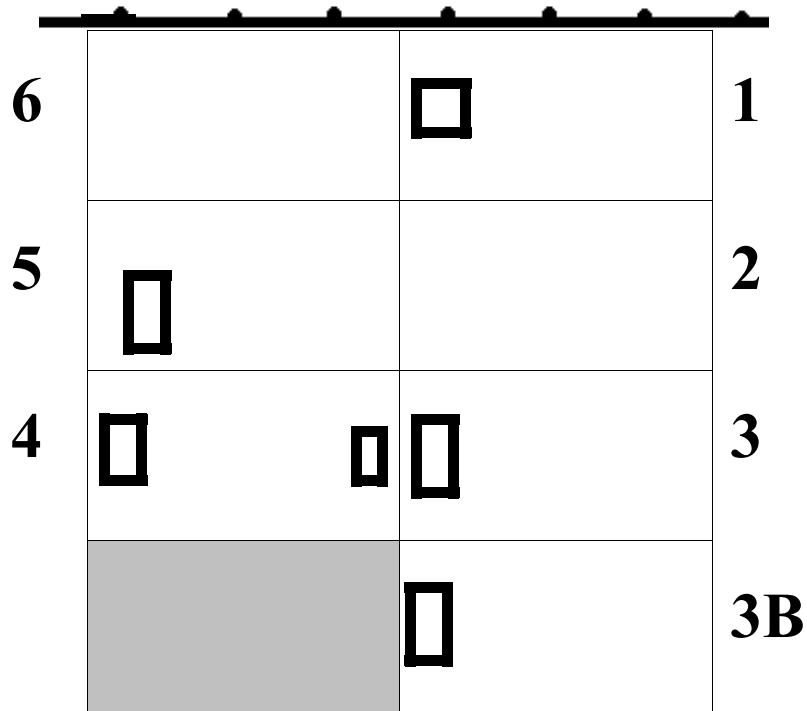

 = perimeter fencing

Plot enclosure: none